

Entrée	10.82	m ²
Cellier	3.82	m ²
Séjour-cuisine	31.63	m ²
Dégt.	2.37	m ²
Chambre 1	10.85	m ²
Wc	1.74	m ²
S d'eau	4.31	m ²
Chambre 2	11.63	m ²
Total	77.17	m²

Annexes	Surfaces
Balcon	13.24 m ²

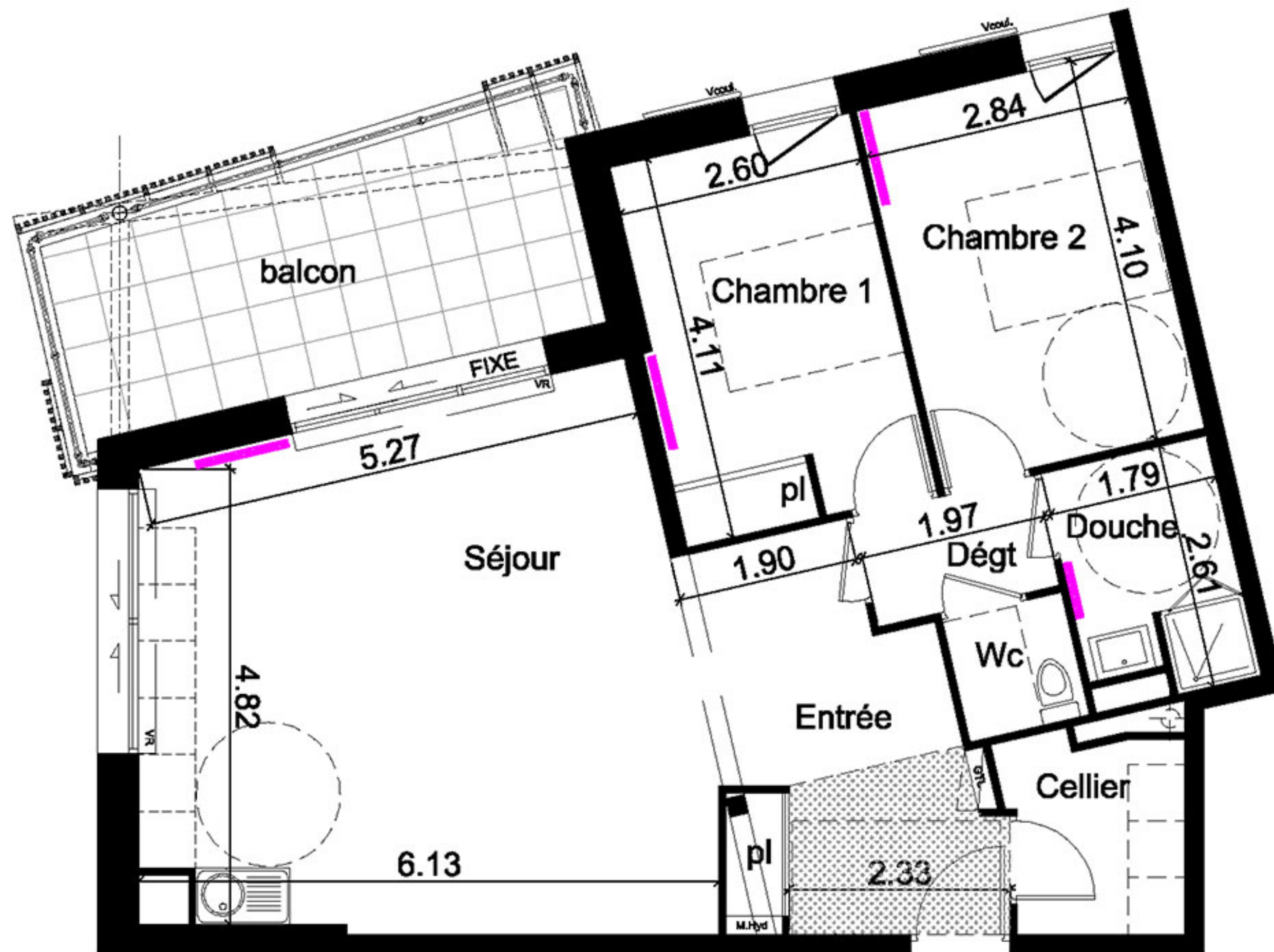

32-T3

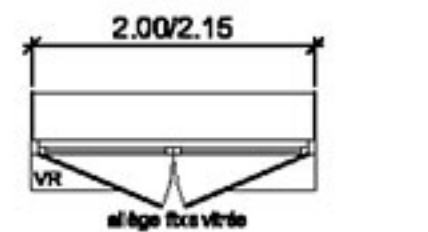
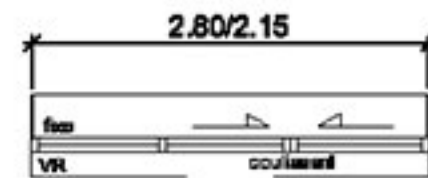
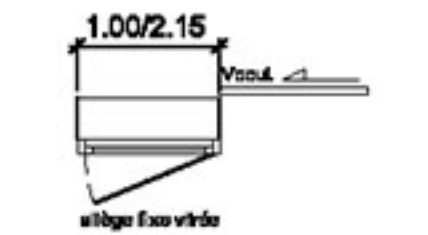
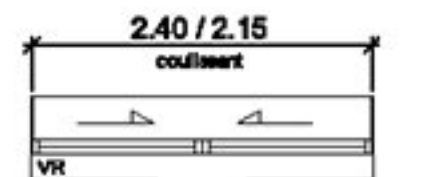
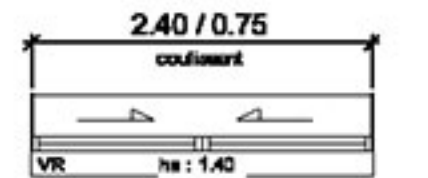

M.Hyd : Modul Hydraulique
GTL: gaine technique de logement.
VR: volet roulant
Vcoul.: volet coulissant
: radiateur